

StatStrip Glu/Ket Meter – Quality Control (QC) Testing Guide

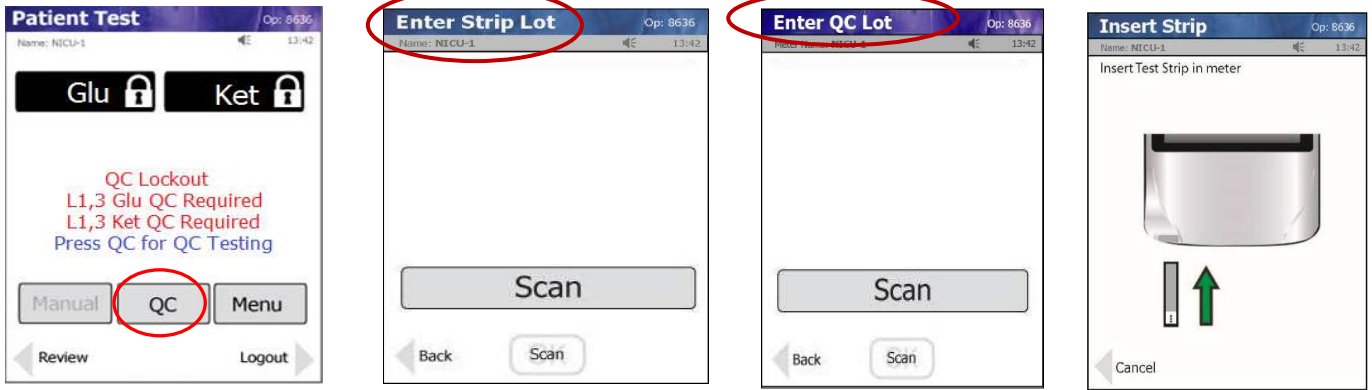

1. Log into device and scan your operator ID. From the Patient Test screen, select **QC**

2. Scan the Strip Lot number (barcode on strip vial):
Blue pot – Glucose
Green pot - Ketones

3. Scan QC Lot number (barcode on QC solution)

4. Insert a Test Strip into the meter

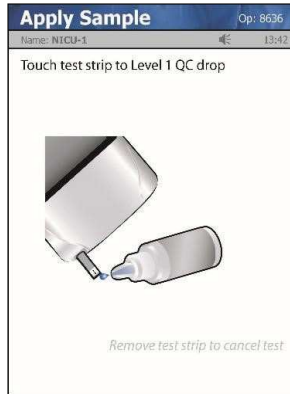

5. Gently invert the QC bottle a few times. Touch the test strip with the QC droplet. **Do not allow QC solution in the strip port**



6. A countdown will then begin:
6 seconds for Glucose
10 seconds for Ketones

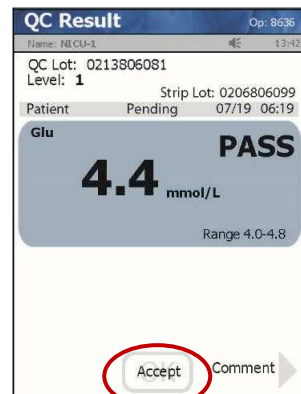

7. The meter will display 'PASS' OR 'FAIL'. Touch **Accept** to complete.

StatStrip meter

Any problems with the meter (including access issues), please contact POCT team, Laboratory Medicine
 EXT: 4050

Glucose/Ketone QC Results

Glucose

Level 1 and Level 3 QC must be performed EVERY 24 hours to unlock the meter

Ketones

Level 1 and Level 3 must be performed BEFORE patient testing to unlock the meter

Remember: When opening fresh QC solutions, write the 3-month expiry date directly on each bottle.

QC Solution

Contact POCT team, Laboratory Medicine
 EXT: 4050